



**ACCENT Studio Furniture  
Configurations**

March 1, 2008

## Standard Furniture Configurations

ACCENT studio furniture is available in several standard models. These configurations, or small variations on these configurations, meets the needs for most studios.

Please feel free to contact the factory with any questions about standard or custom configurations for your studio.

Single Ped Console table

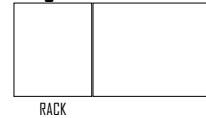

Dual Ped Console table

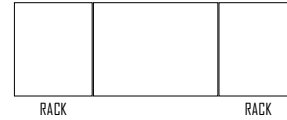

Short 'L' (right handed)

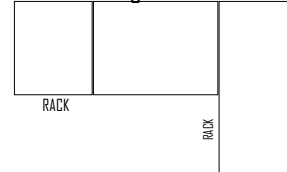

Long 'L' (right handed)

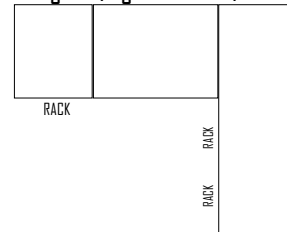

Short 'U'

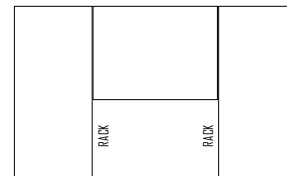

Unbalanced 'U' (right handed)

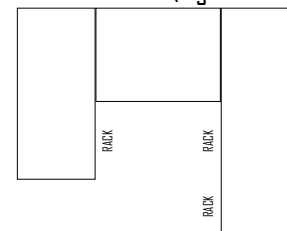

Balanced 'U'

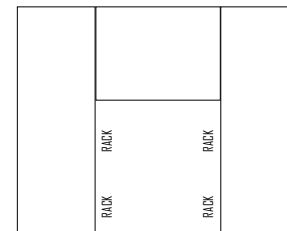

## Single Pedestal Console table configuration

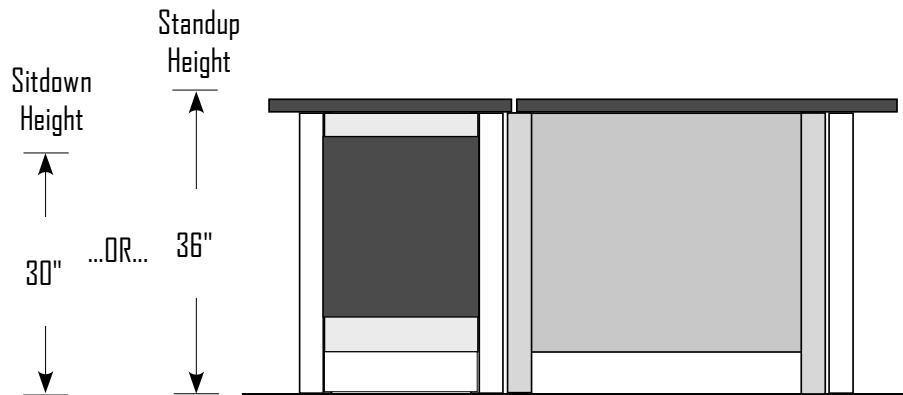
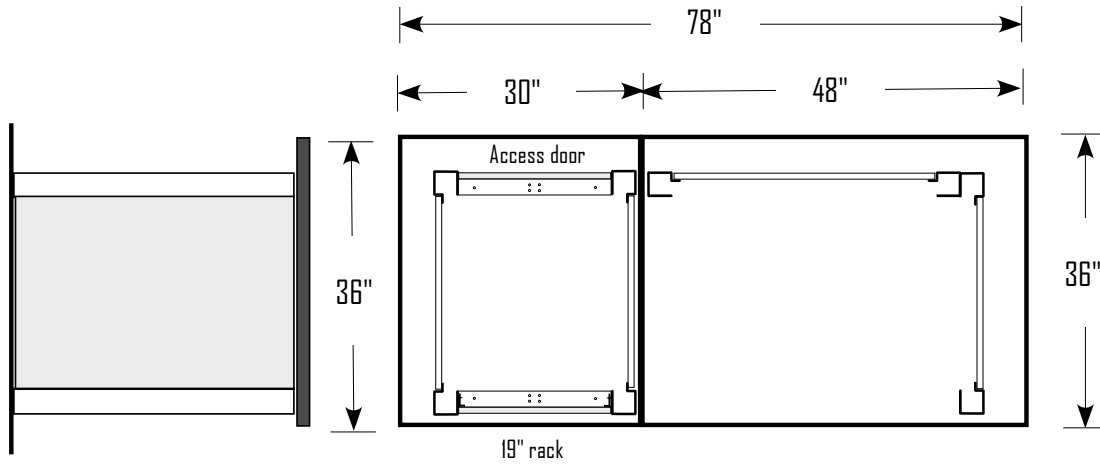

**Note:**

The rear access door can be secured by magnetic touch latch or two screws.

**Pedestal Racks**

Sitdown height = 13RU  
Standup height = 16RU

## Dual Pedestal Console table configuration

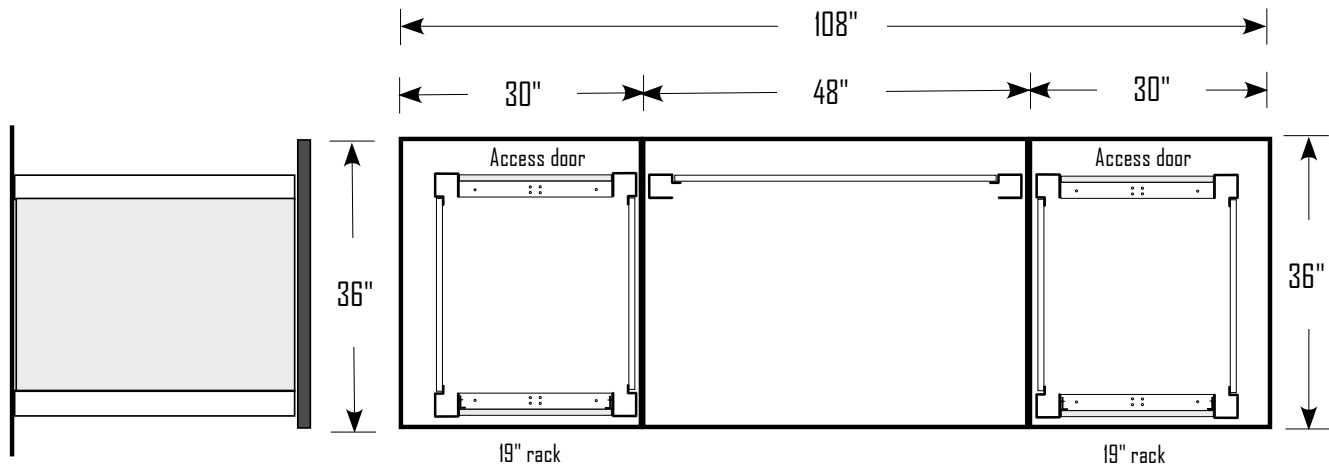

**Note:**

The rear access doors can be secured by magnetic touch latch or two screws.

**Pedestal Racks**

Sitdown height = 13RU  
Standup height = 16RU

## Short 'L' configuration

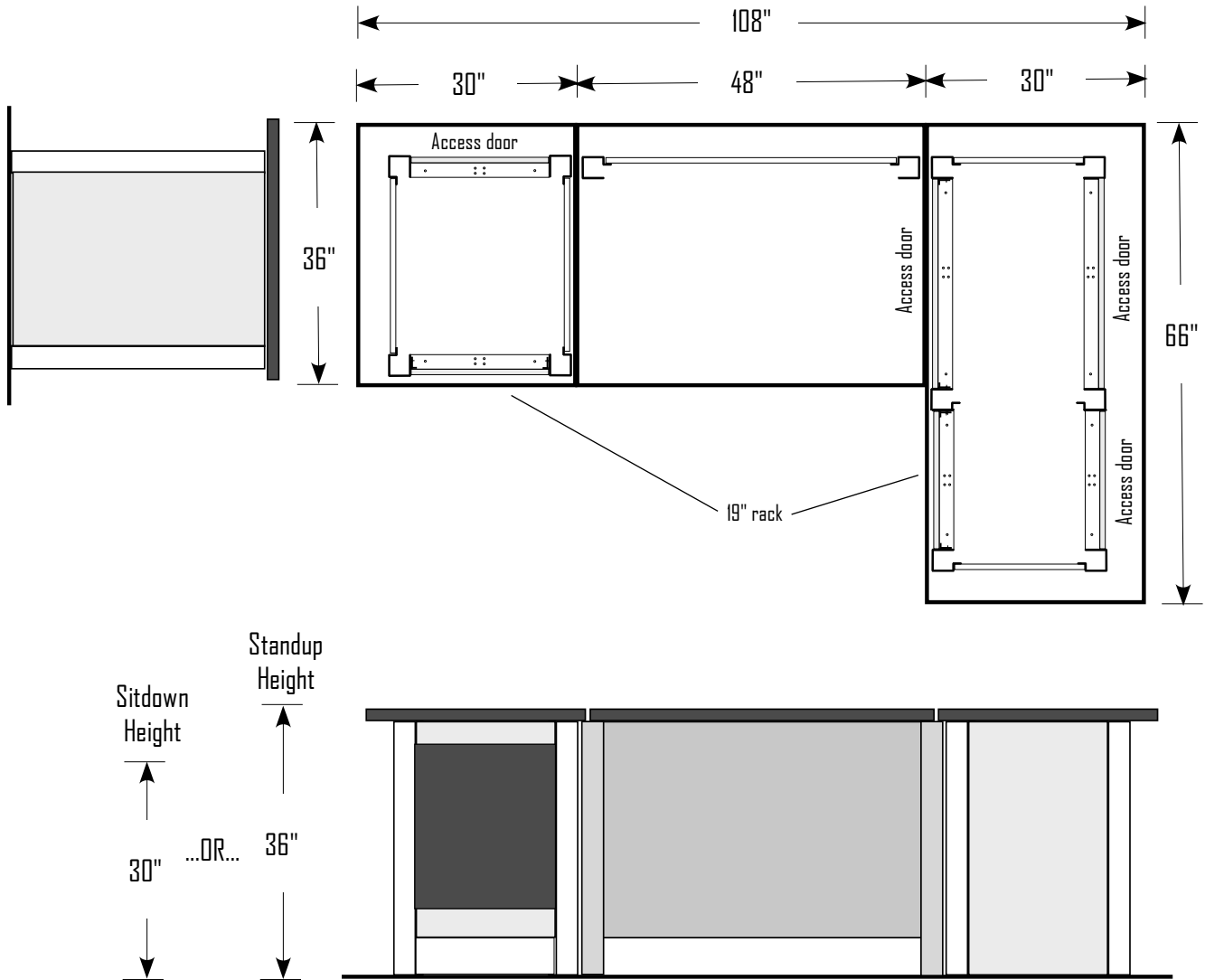

**Note:**

The rear access doors can be secured by magnetic touch latch or two screws.

**Pedestal Racks**

Sitdown height = 13RU  
Standup height = 16RU

## Long 'L' configuration

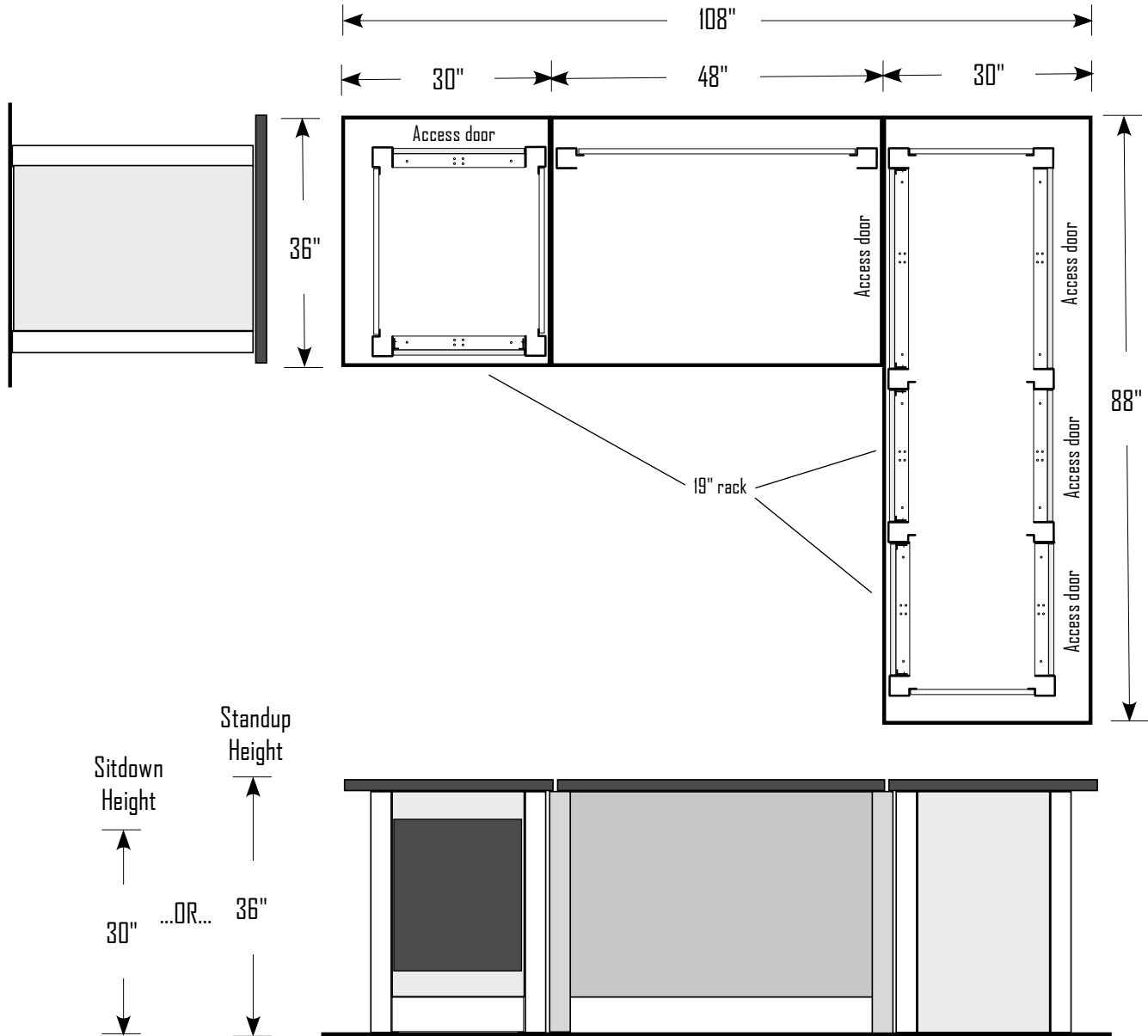

**Note:**

The rear access doors can be secured by magnetic touch latch or two screws.

**Pedestal Racks**

Sitdown height = 13RU  
 Standup height = 16RU

## Short 'U' configuration

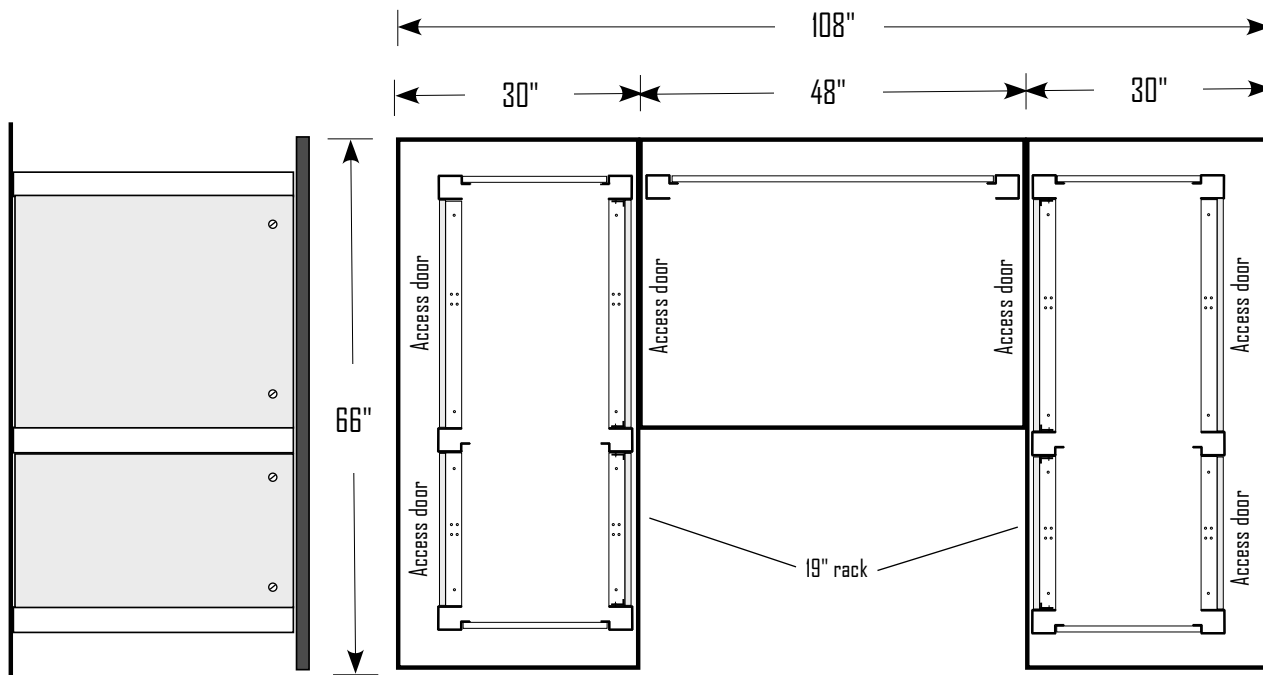

**Note:**

The rear access doors can be secured by magnetic touch latch or two screws.

**Pedestal Racks**

Sitdown height = 13RU  
Standup height = 16RU

## Unbalanced 'U' configuration

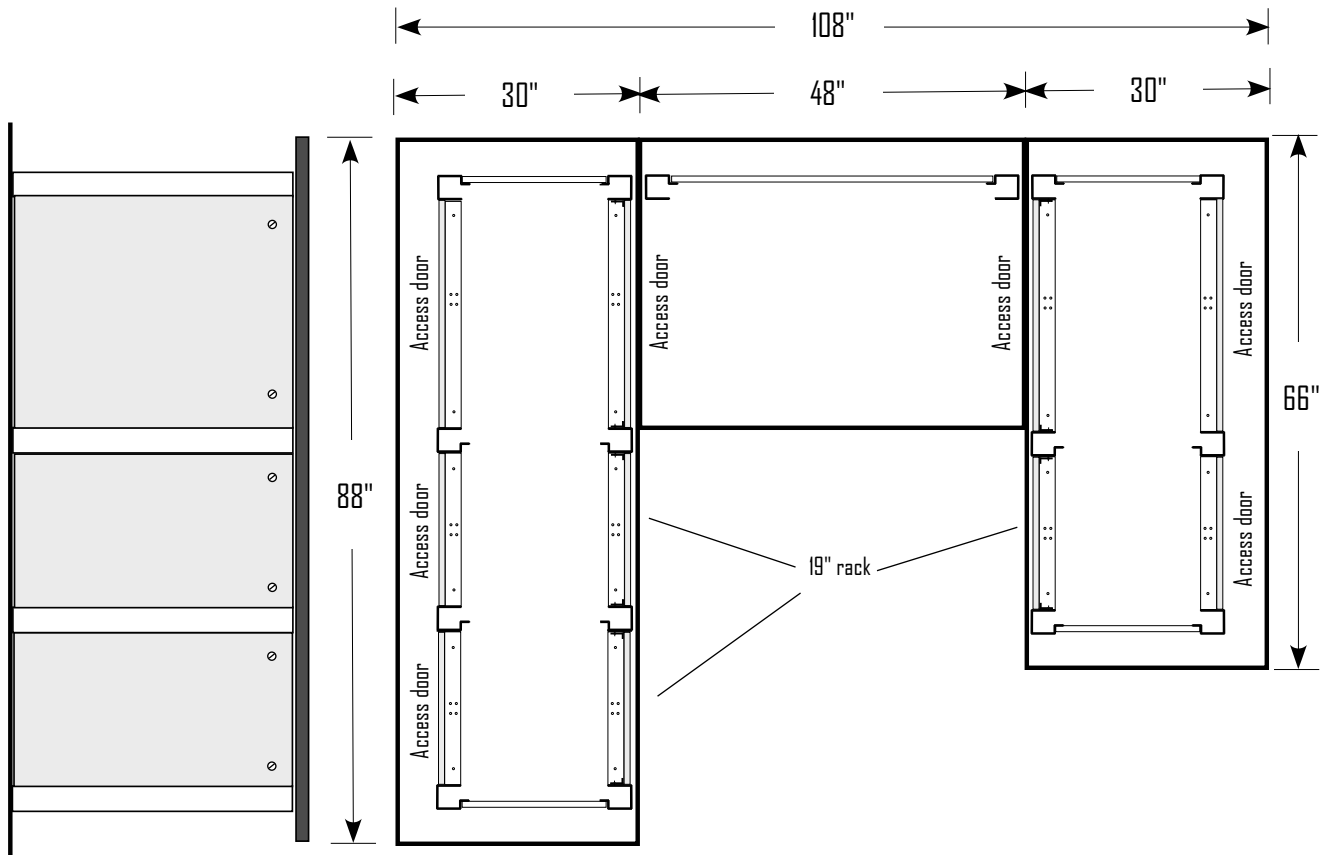

**Note:**

The rear access doors can be secured by magnetic touch latch or two screws.

**Pedestal Racks**

Sitdown height = 13RU  
Standup height = 16RU



## Long 'U' configuration

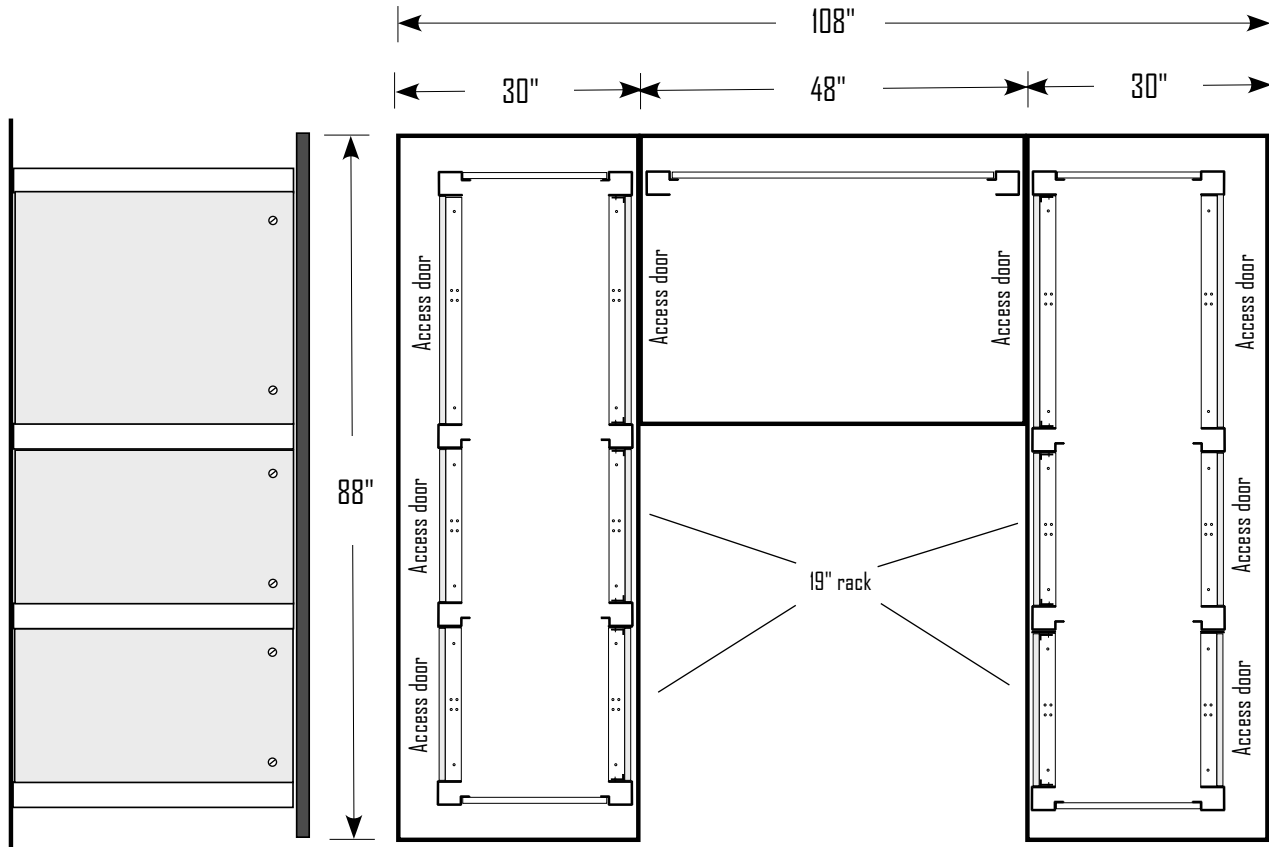

**Note:**

The rear access doors can be secured by magnetic touch latch or two screws.

**Pedestal Racks**

Sitdown height = 13RU  
Standup height = 16RU

## Punch Block Cabinet

The "Punch Block Cabinet" is designed to house wiring and punch blocks (if used). It can also be used simply as a wire channel to conveniently hide console and source gear cabling. The front and rear panels are removable with four screws to provide easy access.

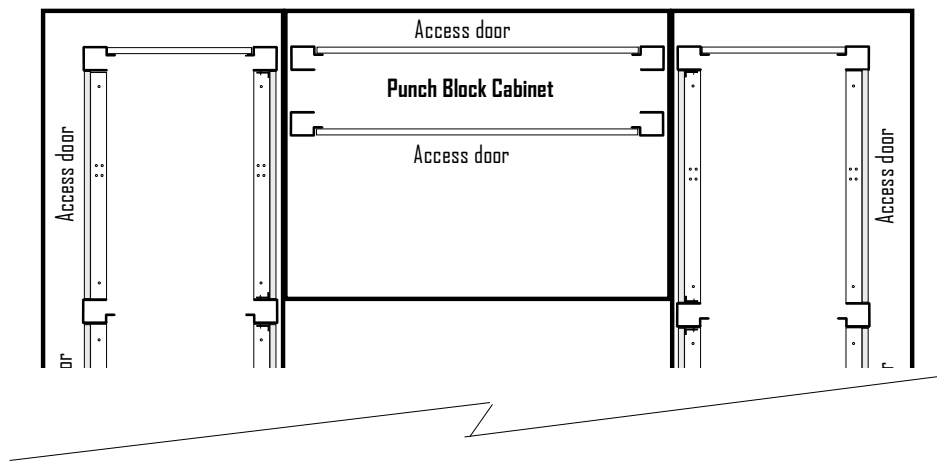

## Knee wells

At times it is desirable to replace a pedestal cabinet with a knee well so that the operator can use certain types of tabletop equipment. The standard ACCESS knee well width is 26". The addition of a 26" knee well adds 7" to the overall length of the pedestal return. Other widths are optionally available.

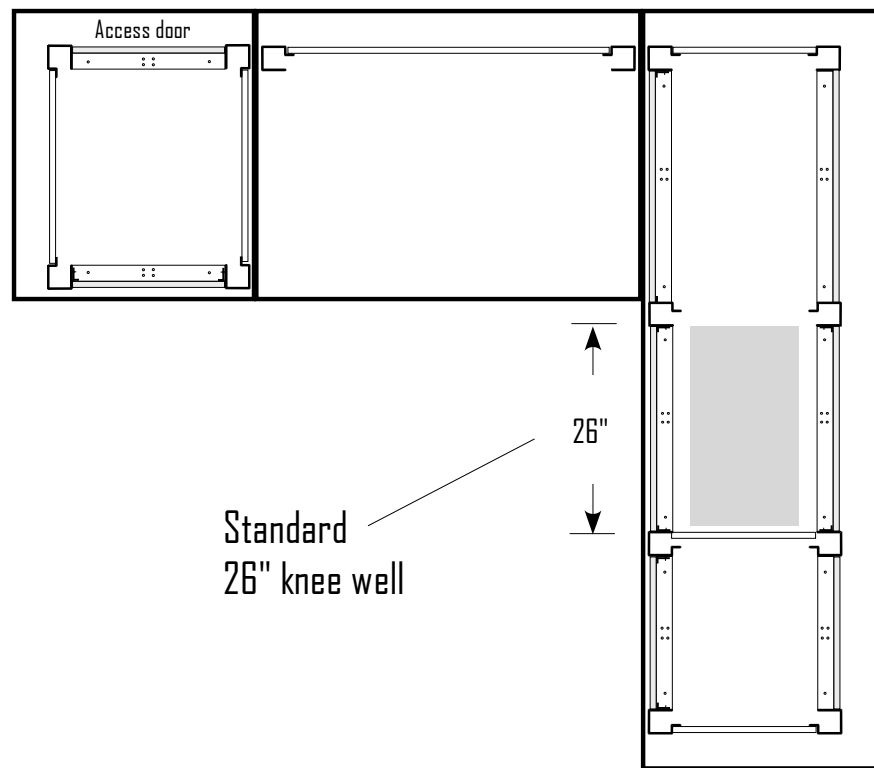

## Left and Right side Interview tables (11" overhang)

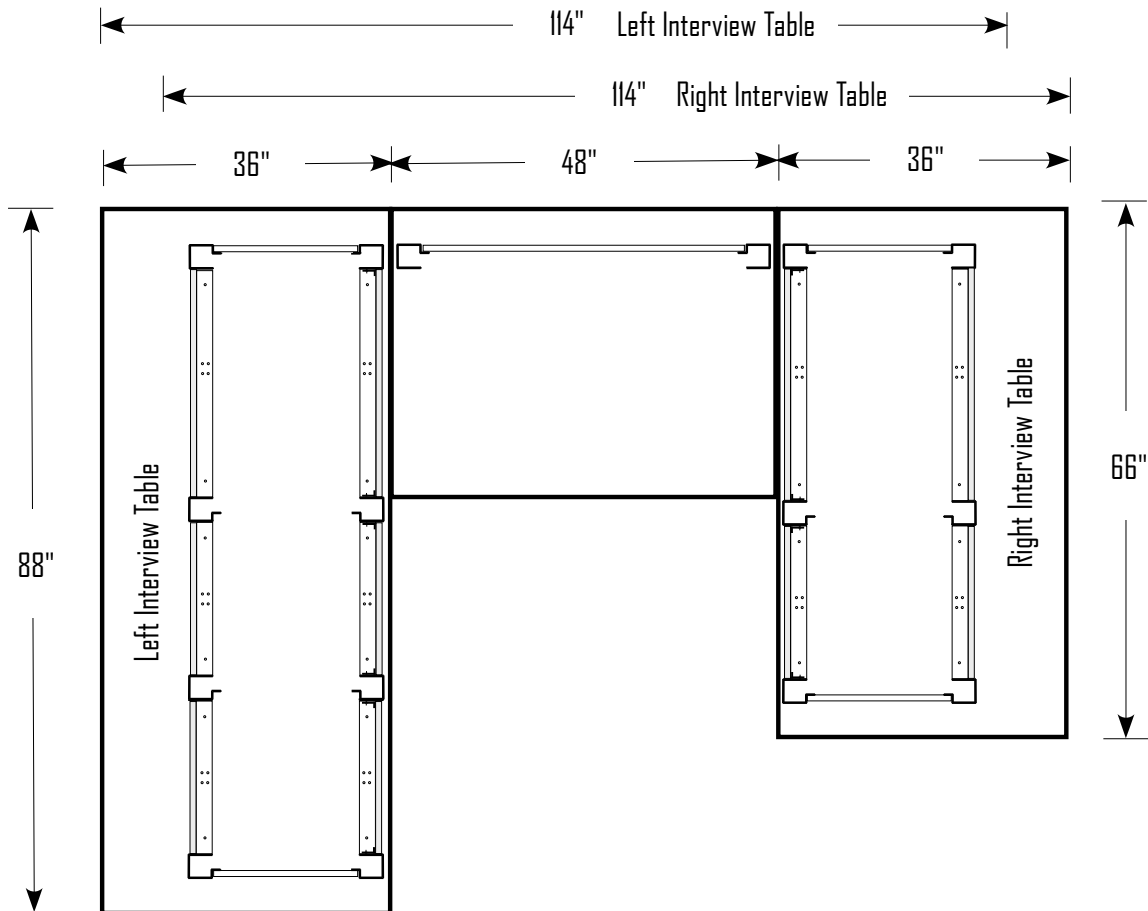

**Note:**

11" is the standard conference desk interview depth. Other interview depths can be custom selected

## Rear Interview table (11" overhang)

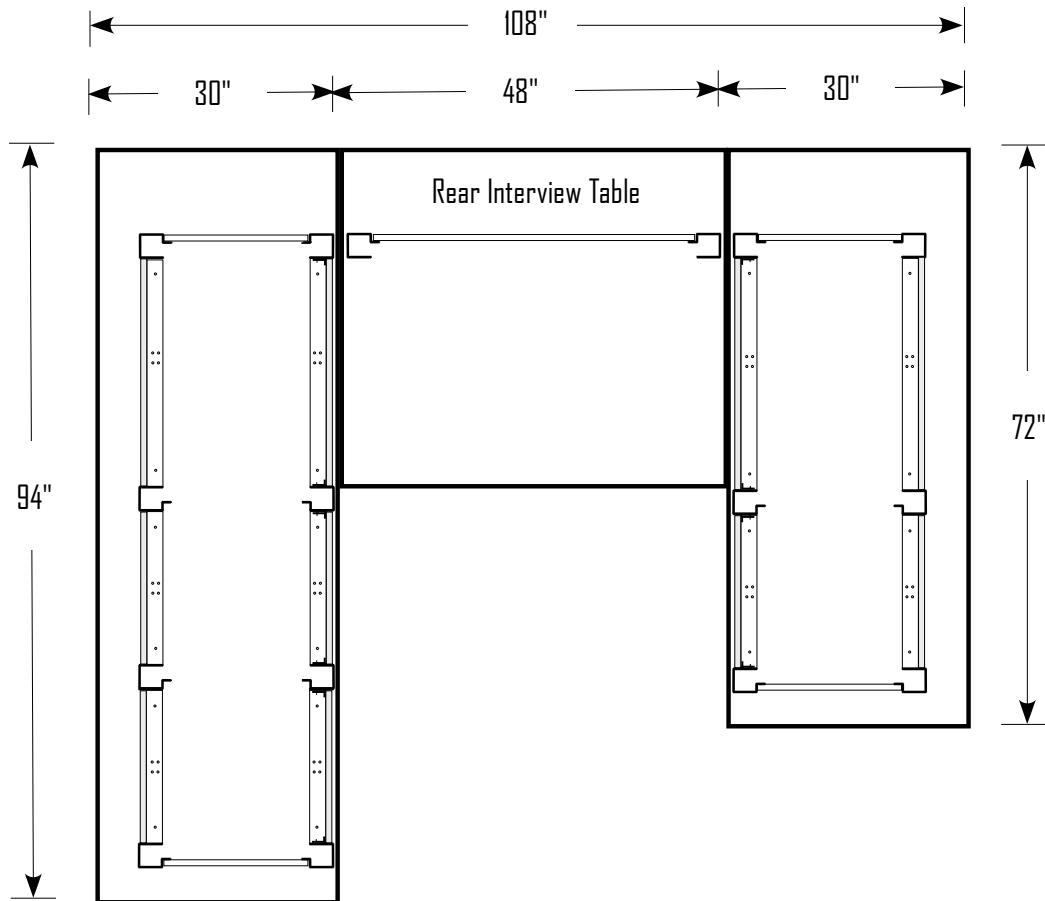

**Note:**

11" is the standard conference desk interview depth. Other interview depths can be custom selected.

## Circular Rear Interview table

Ideal for mic studio applications requiring 3-4 mics, the circular interview table adds style to any studio.

The optional 24" circular mic riser provides an attractive way to manage the mic booms on the table.

Note: the circular table can be placed anywhere around the edges or corners of the studio

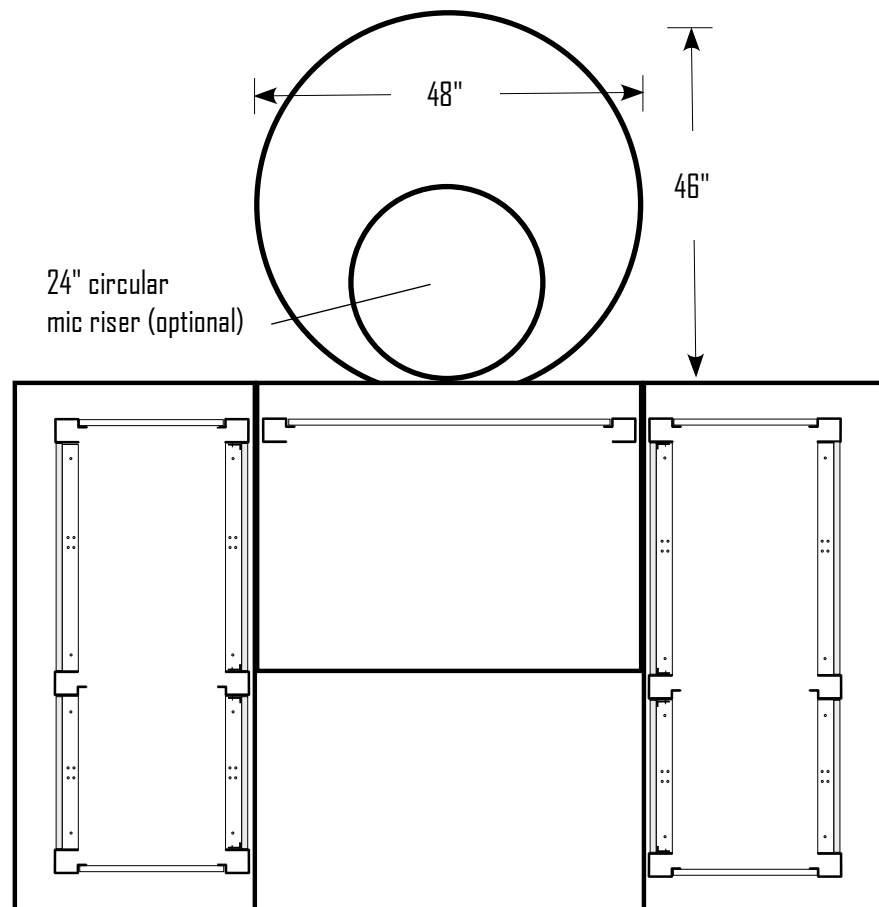

## Tabletop Equipment Rack Pod

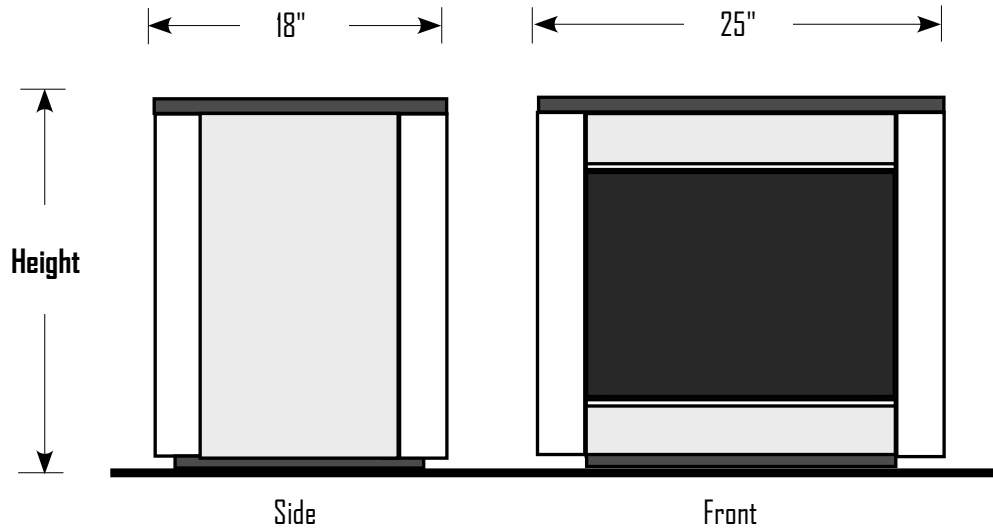

### Height

8RU	Height = 22 1/2"
13RU	Height = 31 1/4"
16RU	Height = 36 1/2"

### Note:

The rear access door can be secured by magnetic touch latch or two screws.